

EXERCISE 7A

INSTRUCTIONS:

1. Start a **NEW** file using **2015-Workbook Helper.dwt**.
2. **Draw** the Lines and one Circle shown below.

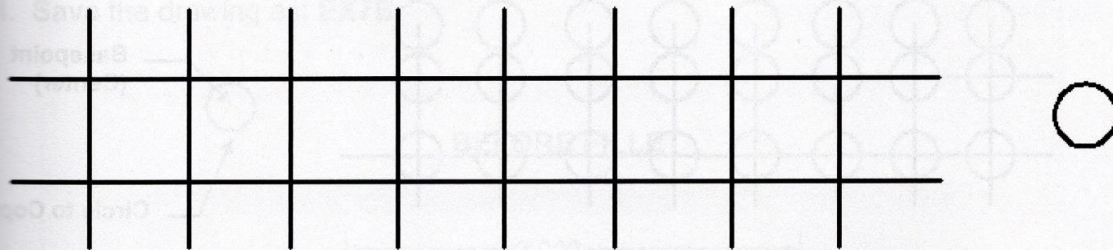

BEFORE COPY

3. Copy the Circle to all of the other locations.
 - A. Select the Copy command
 - B. Select the Circle
 - C. Select the basepoint on the Original Circle.
Note: the basepoints are different.
 - D. Select the New location (2nd point of displacement)
4. **Save** the drawing as: **EX7A**

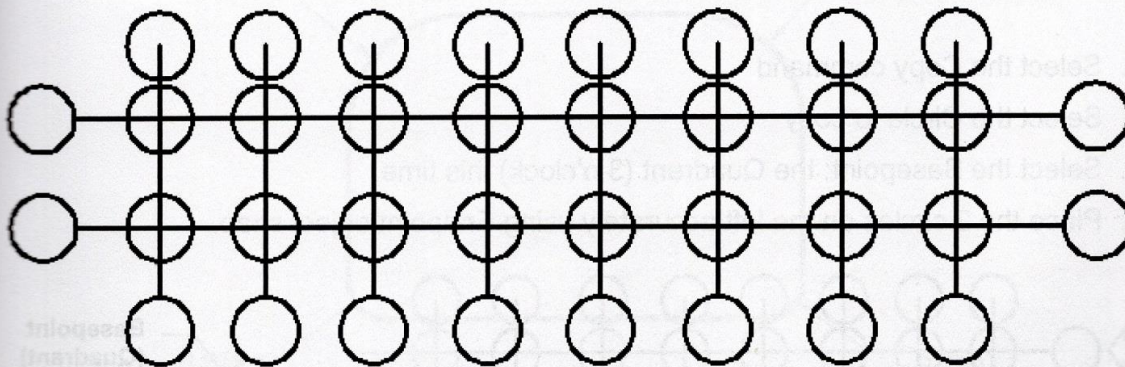

AFTER COPY

Note: Step by step instructions on the next page.

Helpful hints for 7A

1. Select the Copy command
2. Select the Circle
3. Select the Basepoint: the Center of the Circle (use object snap Center)
4. Set Running Object snap to Endpoint and Intersection and place all 24 accurately.

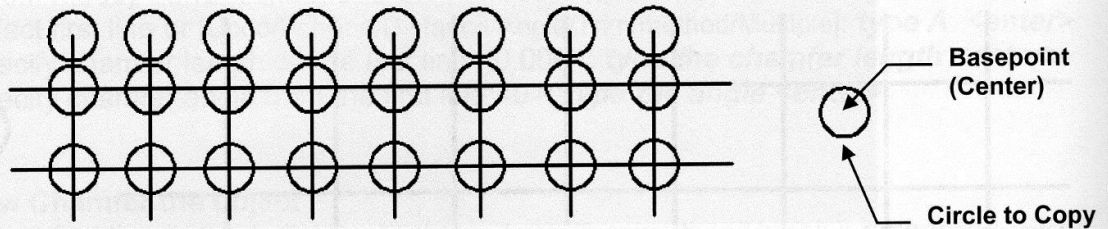

1. Select the Copy command again.
2. Select the Circle to copy
3. Select the Basepoint: the Quadrant (12 o'clock) this time.
4. Place the 8 bottom circles accurately using Endpoint object snap.

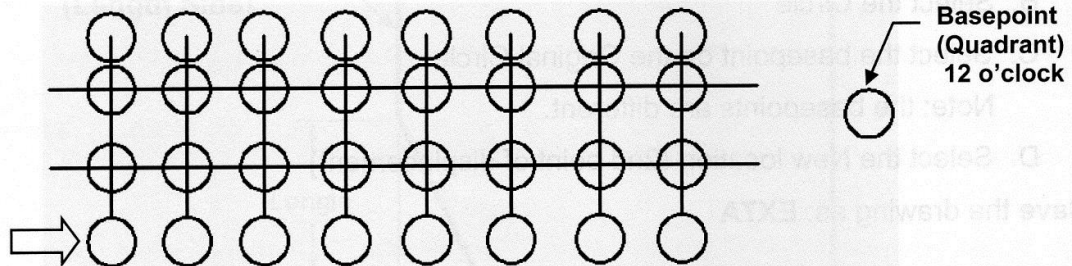

1. Select the Copy command
2. Select the Circle to copy
3. Select the Basepoint: the Quadrant (3 o'clock) this time.
4. Place the 2 circles on the left accurately using Endpoint object snap.

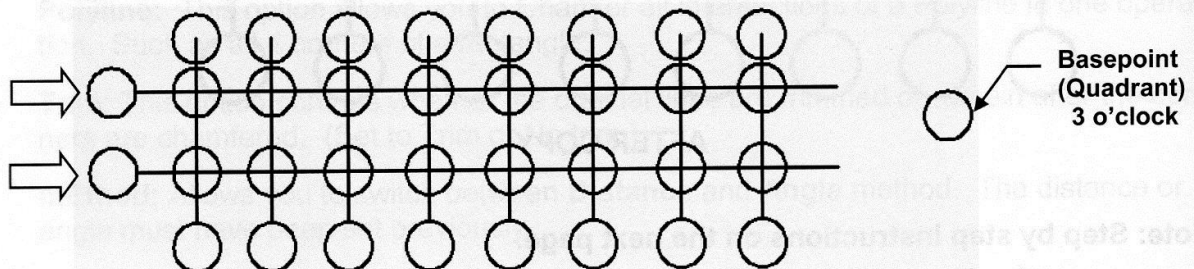

You should be able to figure out the last 2 circles on the right.

EXERCISE 7B

INSTRUCTIONS:

1. Start a **NEW** file using **2015-Workbook Helper.dwt**.
2. **Draw** the Rectangle shown below.
3. Radius the corners using the **Fillet** command.
4. **Save** the drawing as: **EX7B**

BEFORE FILLET

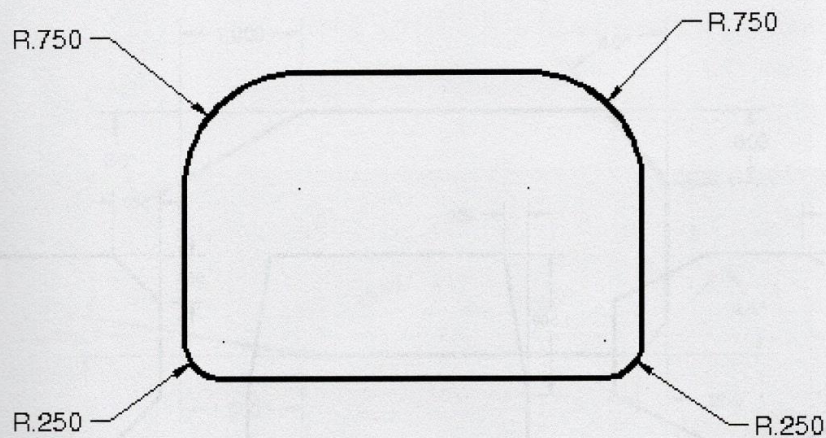
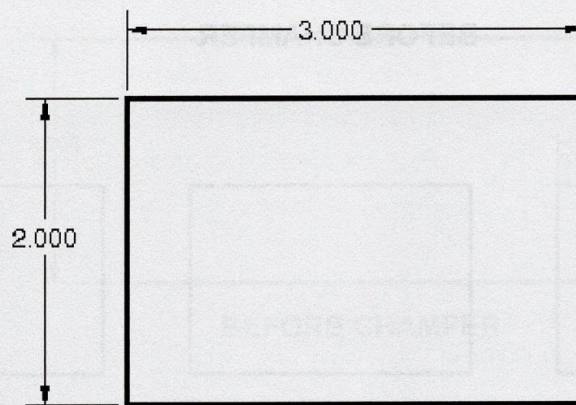

AFTER FILLET

EXERCISE 7C

INSTRUCTIONS:

1. Start a **NEW** file using **2015-Workbook Helper.dwt**.
2. **Draw** the 3 Rectangles shown below.
3. Chamfer the corners using the **Chamfer** command.
4. **Save** the drawing as: **EX7C**

BEFORE CHAMFER

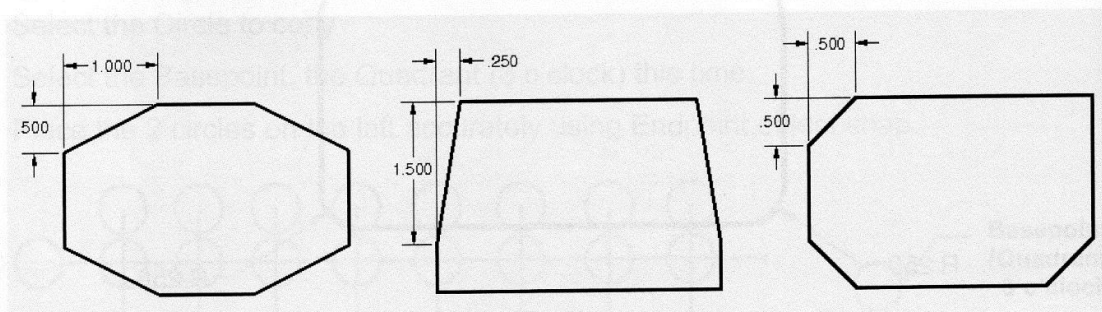
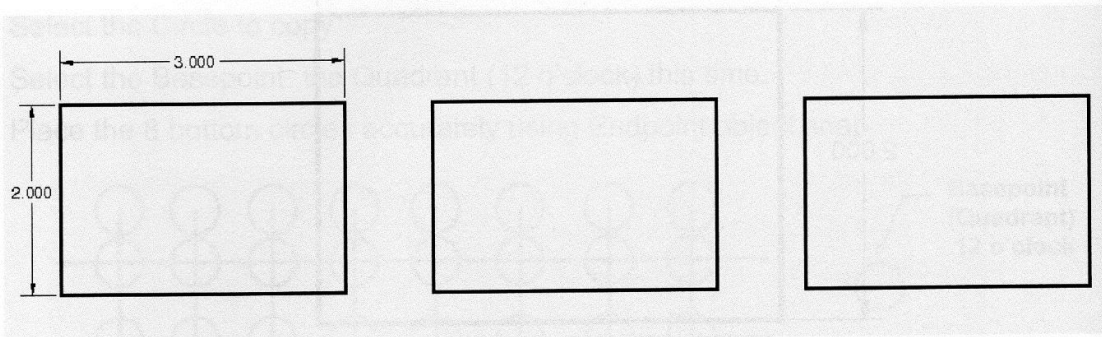

AFTER CHAMFER

EXERCISE 7D

INSTRUCTIONS:

1. Start a **NEW** file using **2015-Workbook Helper.dwt**.
2. Draw the Rectangle shown below.
3. Chamfer the corners using the **Chamfer** command.
4. Save the drawing as: **EX7D**

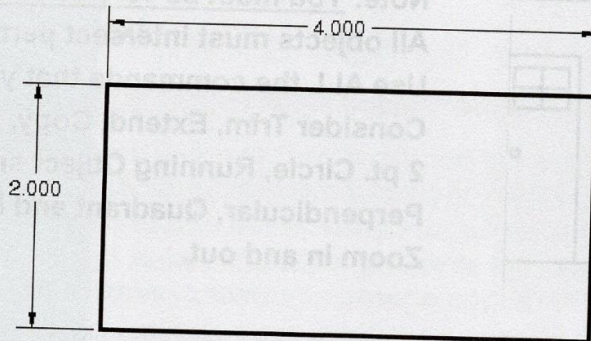

BEFORE CHAMFER

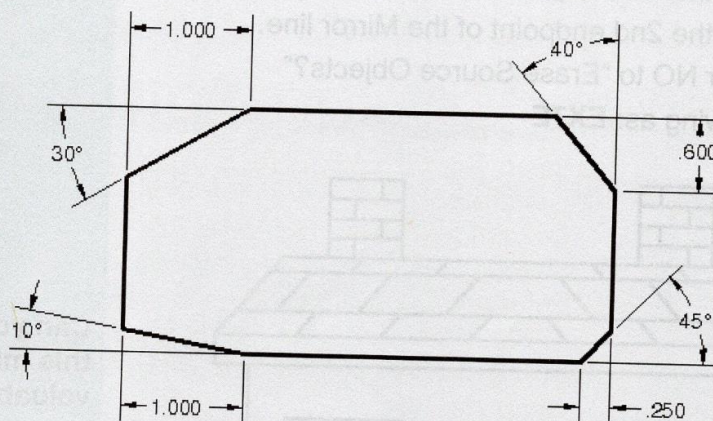

AFTER CHAMFER

EXERCISE 7E

INSTRUCTIONS:

1. Start a **NEW** file using **2015-Workbook Helper.dwt**.
2. **Draw** the "Half house shown below.
Use Layers: Roof, Wall, Window, Door, Plants and Bricks.

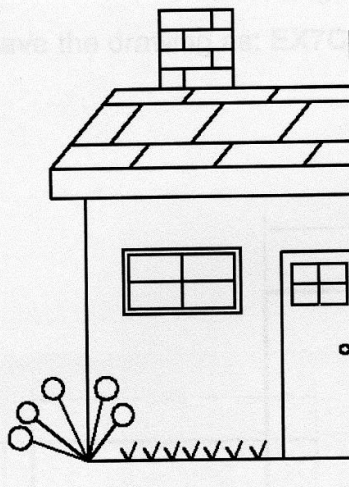

**Hint: Draw this line first.
Also snap to it for the Mirror Line.
Your halves should match perfectly.**

**Note: You must be very accurate.
All objects must intersect perfectly.
Use ALL the commands that you have learned.
Consider Trim, Extend, Copy, Rectangle,
2 pt. Circle, Running Object snap: Nearest,
Perpendicular, Quadrant and Endpoint.
Zoom in and out.**

3. Now create a Mirrored image of the half house:
 - A. Select the Mirror command.
 - B. Select the objects to be Mirrored (You could use Window selection).
 - C. Select the 1st endpoint of the Mirror line (Ortho ON).
 - D. Select the 2nd endpoint of the Mirror line.
 - E. Answer NO to "Erase Source Objects?"
4. **Save** the drawing as: **EX7E**

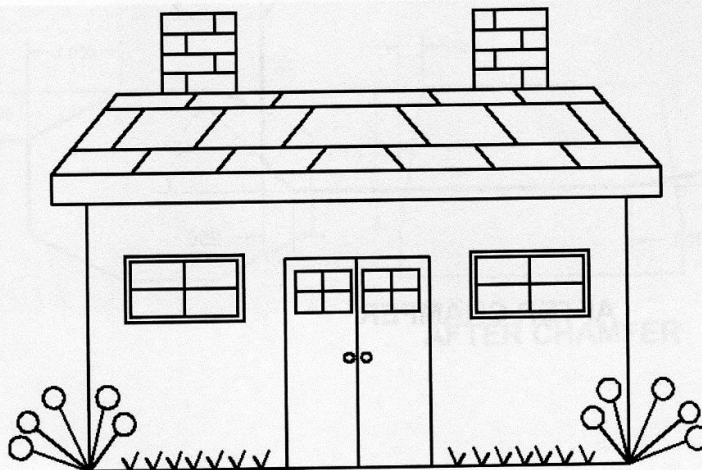

**Can you imagine how
this might save you
valuable time?**