

Exercise 7E

Exercise 7E

Instructions:

1. Start a **New** file using either the **inch-helper.dwt** or the **metric-helper.dwt**
2. Draw the half the house shown below.

Use Layers Roof, Wall, Window, Door, Plants, and Bricks.

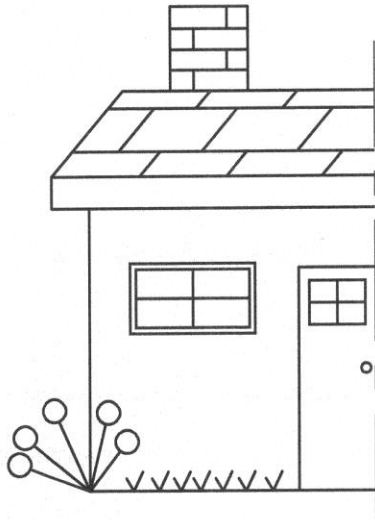

Hint: Draw this line first. Also snap to it for the Mirror line. Your halves should match perfectly.

Note: You must be very accurate. All objects must intersect perfectly. Use **ALL** the commands that you have learned. Consider Trim, Extend, Copy, Rectangle, 2-Point Circle, Running Object Snap: Nearest, Perpendicular, Quadrant, and Endpoint. Zoom in and out.

3. Now create a Mirrored image of the half house:
 - A. Select the Mirror command.
 - B. Select the objects to be Mirrored (you could use Window selection).
 - C. Select the first endpoint of the Mirror line (Ortho **ON**).
 - D. Select the second endpoint of the Mirror line.
 - E. Answer **NO** to "Erase Source Objects?"
4. **Save** the drawing as: **Ex-7E**

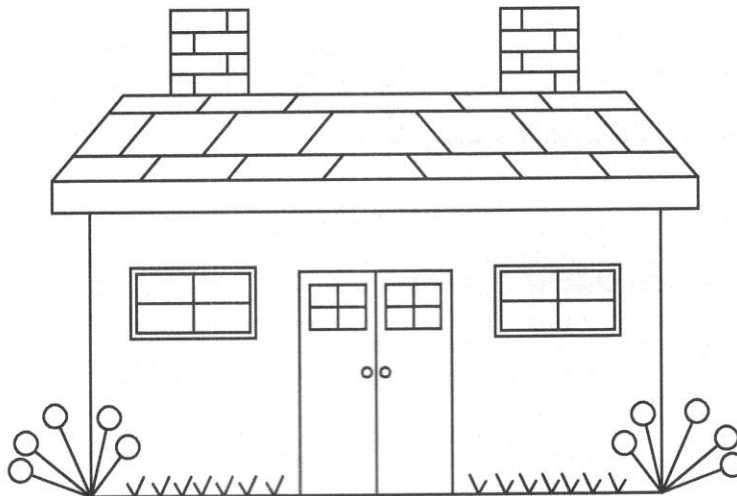

Can you imagine how this might save you valuable time?